



## Series FS4-3RP-T Manual Testing

- a) Place cover on flow switch making sure the test lever is protruding through the appropriate slot in the cover. Check to make sure the lever doesn't bind with the cover as noted in figure 1.
- b) Initiate fluid flow through the system. Observe that the dependent boiler device is being activated by the flow switch to determine if the flow switch is operating as required.
- c) Turn off fluid flow to determine that the dependent device changes state, returning to its original condition.
- d) Repeat steps b and c several times.
- e) If system operation is correct, turn on system fluid flow and push the manual test lever down as shown in figure 2. Observe the dependent device changing state.
- f) Release the test lever and observe the system returning to its original state.
- g) Repeat steps e and f several times to test the flow switch and its dependent device for proper operation.

If the flow switch does not operate properly see troubleshooting section on the last page of MM-601.

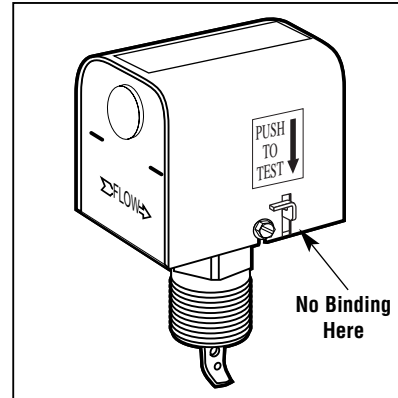

Figure 1

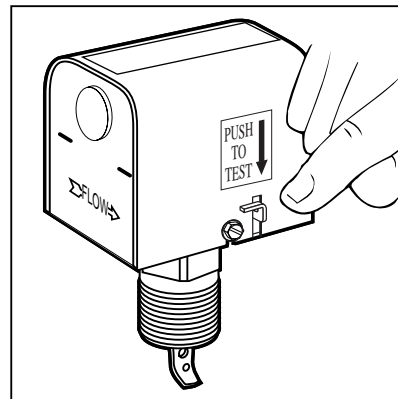

Figure 2

## McDonnell & Miller



ITT Industries  
*Engineered for life*

3500 N. Spaulding Avenue  
Chicago, Illinois 60618  
tel: 773 267-1600  
fax: 773 267-0991  
www.mcdonnellmiller.com

©2001 ITT Industries Inc.  
Printed in U.S.A. 10-01 210293